

## eVolve Fabrication for Revit MEP

### Brief Synopsis of Class Contents:

This live, instructor-led online class covers the basics of eVolve. Students will learn about proper project setup, be introduced to the differences between eVolve and Revit MEP Systems, and become familiar with vast library of content. Students will learn how to place and manipulate the eVolve content to create LOD 400 fabrication models. Students will also learn how to use eVolve's View and Sheet Creator to create detailed spool sheets with the detailing tools that are in the eVolve program.

### Learning Objectives:

- Understand the role of eVolve in the development of electrical prefabrication industry.
- Learn how to place eVolve content.
- Learn how to use Revit phases to set up spool drawings.
- Create BOM reports
- Use eVolve tools to assist in detailing.

### Courseware:

Applied Software Handouts

### Number of Days:

3 Half Day Sessions

### Continuing Education Hours:

10 hours

### Who Should Attend:

Revit users needing to develop Prefabrication drawings for the electrical industry.

### Prerequisites:

Mastery of content of Revit MEP Fundamentals class or equivalent work experience.

### System and Software Requirements:

<http://www.asti.com/LiveLab-Learning-amp-Training/LiveLab-System-Requirements>

### FAQs and Cancellation Policy:

<http://www.asti.com/LiveLab-Learning-amp-Training/LiveLab-FAQS>

## Class Outline and Topics:

### Introduction / Overview

- Software Installation
- System Families Vs. Component Families
- User Interface
- Working with Project Templates
- Working with Shared Parameters

### Project Set Up

- Creating Phases
- Working with View Templates

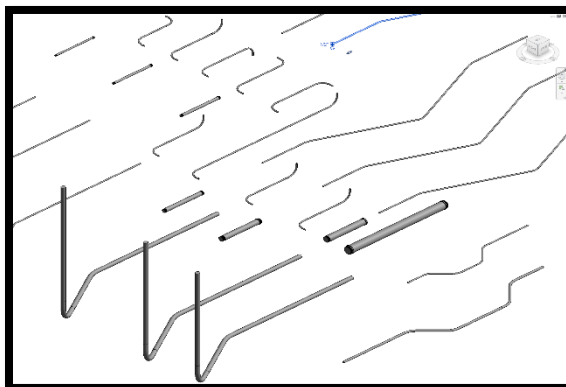

### Placing Content

- Conduit/Fittings
- Working with Couplings
- Placing Bodies, Boxes, Equipment
- Placing PreFab Assemblies
- Placing Struts & Hangers
- Working with Wireway & Fittings
- Working with Busduct
- Working with non-eVolve parts and Unifying with Project Parameters

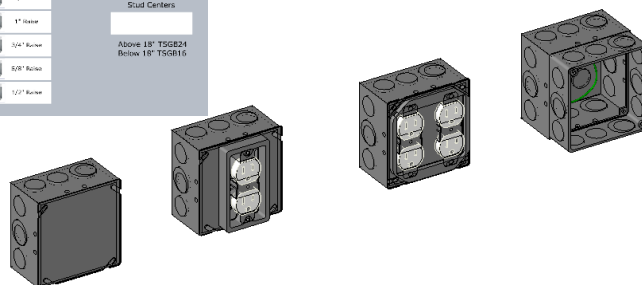

### Project Workflow

- Assigning Phases to Components
- Overriding Graphics of Components
- Tracking Components
- View & Sheet Creator

### Documentation

- Creating and Using eVolve Schedules
- Documentaion Tools
- Export Req Form
- eVolve Toolbox Tools
- eVolve Visibility & Filter Tools

